

- *Index*
- *Cabinet Selection*
- *Frame with Doors*

Wall Cabinetry

Page Location	Cabinet Type	Nomenclature
75	Door Face Frame	DRFF
74	Lift-Up Door Appliance Garage	BLUM
74	Range Hood	RH
65-66	Wall	W
67	Wall - Depth 15"	W
68	Wall - Depth 24"	W
67	Wall - Depth 9"	W
71	Wall Blind Corner	WBC
71-72	Wall Blind End Corner	WBEC
70	Wall Corner	WC
70	Wall Corner Lazy Susan	WCLS
68-69	Wall Double Face	WDF
70	Wall Double Face Corner	WDFC
73-74	Wall Drawer	WD
72	Wall End Corner	WEC
72	Wall End Corner Double Face	WECDF
70	Wall Microwave Cabinet	MW
69	Wall Pigeon Hole	WPH
69	Wall Plate Rack	WPR
69	Wine Rack Lattice	WRL
74	Wine Rack Diagonal	WRD
69	Wine Stem Rack	WSR

Wall Cabinetry : Cabinet Selection

Wall Cabinets

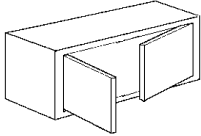
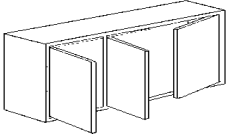
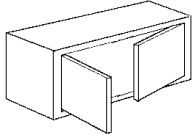
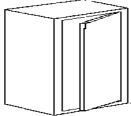
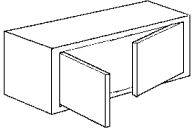
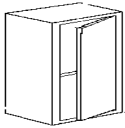
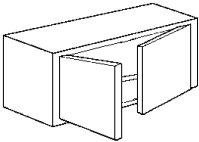
		W	H	D	Cabinet Doors	
Wall - Height 12" (Double Door)						
<i>Frame Construction</i>						
	W3012	30	12	12	◆ (2) DR1512	No Shelf
	W3312	33	12	12	◆ (2) DR1612	
	W3612	36	12	12	◆ (2) DR1812	
	W3912	39	12	12	◆ (2) DR1912	
	W4212	42	12	12	◆ (2) DR2112	
	W4812 L/R	48	12	12	◆ (1) DR1512 (2) DR1612	No Shelf L/R designates hinging of single door
Wall - Height 15" (Double Door)						
<i>Frame Construction</i>						
	W3015	30	15	12	◆ (2) DR1515	No Shelf
	W3315	33	15	12	◆ (2) DR1615	
	W3615	36	15	12	◆ (2) DR1815	
	W3915	39	15	12	◆ (2) DR1915	
Wall - Height 18"						
<i>Frame Construction</i>						
	W0918 L/R	9	18	12	◆ (1) DR0918	No Shelf
	W1218 L/R	12	18	12	◆ (1) DR1218	
	W1518 L/R	15	18	12	◆ (1) DR1518	
	W1818 L/R	18	18	12	◆ (1) DR1818	
	W2118 L/R	21	18	12	◆ (1) DR2118	
	W2418	24	18	12	◆ (2) DR1218	No Shelf
	W2718	27	18	12	◆ (2) DR1318	
	W3018	30	18	12	◆ (2) DR1518	
	W3318	33	18	12	◆ (2) DR1618	
	W3618	36	18	12	◆ (2) DR1818	
	W3918	39	18	12	◆ (2) DR1918	
Wall - Height 24"						
<i>Frame Construction</i>						
	W1524 L/R	15	23 ^{5/8}	12	◆ (1) DR1524	1 Adjustable Shelf
	W1824 L/R	18	23 ^{5/8}	12	◆ (1) DR1824	
	W2424	24	23 ^{5/8}	12	◆ (2) DR1224	1 Adjustable Shelf
	W2724	24	23 ^{5/8}	12	◆ (2) DR1324	
	W3024	30	23 ^{5/8}	12	◆ (2) DR1524	
	W3324	33	23 ^{5/8}	12	◆ (2) DR1624	
	W3624	36	23 ^{5/8}	12	◆ (2) DR1824	
	W3924	39	23 ^{5/8}	12	◆ (2) DR1924	
	W4224	36	23 ^{5/8}	12	◆ (2) DR2124	

Wall Cabinetry : Cabinet Selection

Wall Cabinets		W	H	D	Cabinet Doors	Frame Construction
Wall - Height: 30"						
	W0930 L/R	9	30 ^{9/16}	12	◆ (1) DR0930	2 Adjustable Shelves L/R designates hinging of door
	W1230 L/R	12	30 ^{9/16}	12	◆ (1) DR1230	
	W1530 L/R	15	30 ^{9/16}	12	◆ (1) DR1530	
	W1830 L/R	18	30 ^{9/16}	12	◆ (1) DR1830	
	W2130 L/R	21	30 ^{9/16}	12	◆ (1) DR2130	
	W2430	24	30 ^{9/16}	12	◆ (2) DR1230	2 Adjustable Shelves
	W2730	27	30 ^{9/16}	12	◆ (2) DR1330	
	W3030	30	30 ^{9/16}	12	◆ (2) DR1530	
	W3330	33	30 ^{9/16}	12	◆ (2) DR1630	
	W3630	36	30 ^{9/16}	12	◆ (2) DR1830	
	W4230	42	30 ^{9/16}	12	◆ (2) DR2130	
	W3930 L/R	39	30 ^{9/16}	12	◆ (1) DR1230 (2) DR1330	2 Adjustable Shelves L/R designates hinging of single door
	Wall - Height: 36"					
	W0936 L/R	9	36	12	◆ (1) DR0936	2 Adjustable Shelves L/R designates hinging of door
	W1236 L/R	12	36	12	◆ (1) DR1236	
	W1536 L/R	15	36	12	◆ (1) DR1536	
	W1836 L/R	18	36	12	◆ (1) DR1836	
	W2136 L/R	21	36	12	◆ (1) DR2136	
	W2436	24	36	12	◆ (2) DR1236	2 Adjustable Shelves
	W2736	27	36	12	◆ (2) DR1336	
	W3036	30	36	12	◆ (2) DR1536	
	W3336	33	36	12	◆ (2) DR1636	
	W3636	36	36	12	◆ (2) DR1836	
	W4236	42	36	12	◆ (2) DR2136	
	W3936 L/R	39	36	12	◆ (1) DR1236 (2) DR1336	2 Adjustable Shelves L/R designates hinging of single door
	Wall - Height: 42"					
	W0942 L/R	9	41 ^{7/8}	12	◆ (1) DR0942	3 Adjustable Shelves L/R designates hinging of door
	W1242 L/R	12	41 ^{7/8}	12	◆ (1) DR1242	
	W1542 L/R	15	41 ^{7/8}	12	◆ (1) DR1542	
	W1842 L/R	18	41 ^{7/8}	12	◆ (1) DR1842	
	W2142 L/R	21	41 ^{7/8}	12	◆ (1) DR2142	
	W2442	24	41 ^{7/8}	12	◆ (2) DR1242	3 Adjustable Shelves
	W2742	27	41 ^{7/8}	12	◆ (2) DR1342	
	W3042	30	41 ^{7/8}	12	◆ (2) DR1542	
	W3342	33	41 ^{7/8}	12	◆ (2) DR1642	
	W3642	36	41 ^{7/8}	12	◆ (2) DR1842	
	W4242	42	41 ^{7/8}	12	◆ (2) DR2142	
	W3942 L/R	39	41 ^{7/8}	12	◆ (1) DR1242 (2) DR1342	3 Adjustable Shelves L/R designates hinging of single door
	Wall - Height: 48"					
Available In Vassar House Series Only						
	W1248 L/R	12	48	12	◆ (1) DR1248	3 Adjustable Shelves L/R designates hinging of door
	W1548 L/R	15	48	12	◆ (1) DR1548	
	W1848 L/R	18	48	12	◆ (1) DR1848	
	W2148 L/R	21	48	12	◆ (1) DR2148	
	W2448	24	48	12	◆ (2) DR1248	3 Adjustable Shelves
	W2748	27	48	12	◆ (2) DR1348	
	W3048	30	48	12	◆ (2) DR1548	
	W3348	33	48	12	◆ (2) DR1648	
	W3648	36	48	12	◆ (2) DR1848	

Wall Cabinetry : Cabinet Selection

Wall Cabinets

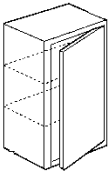
	W	H	D	Cabinet Doors		
Wall - Depth: 09" (Single Door) Not Offered In Gatehouse Series						
	Frame Construction					
	W153009 L/R	15	30 ^{9/16}	9	◆ (1) DR1530	[(2) shelves
	W183009 L/R	18	30 ^{9/16}	9	◆ (1) DR1830	
	W153609 L/R	15	36	9	◆ (1) DR1536	[(2) shelves
	W183609 L/R	18	36	9	◆ (1) DR1836	
	W154209 L/R	15	41 ^{7/8}	9	◆ (1) DR1542	[(3) shelves
W184209 L/R	18	41 ^{7/8}	9	◆ (1) DR1842		

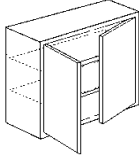
Wall - Depth: 09" (Double Door) Not Offered In Gatehouse Series						
	Frame Construction					
	W303009	30	30 ^{9/16}	9	◆ (2) DR1530	[(2) shelves
	W363009	36	30 ^{9/16}	9	◆ (2) DR1830	
	W303609	30	36	9	◆ (2) DR1536	[(2) shelves
	W363609	36	36	9	◆ (2) DR1836	
	W304209	30	41 ^{7/8}	9	◆ (2) DR1542	[(3) shelves
W364209	36	41 ^{7/8}	9	◆ (2) DR1842		

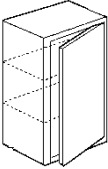
Wall - Depth: 15" (Single Door) Not Offered In Gatehouse Series						
	Frame Construction					
	W153015 L/R	15	30 ^{9/16}	15	◆ (1) DR1530	[(2) 15" deep shelves
	W183015 L/R	18	30 ^{9/16}	15	◆ (1) DR1830	
	W153615 L/R	15	36	15	◆ (1) DR1536	[(2) 15" deep shelves
	W183615 L/R	18	36	15	◆ (1) DR1836	
	W154215 L/R	15	41 ^{7/8}	15	◆ (1) DR1542	[(3) 15" deep shelves
W184215 L/R	18	41 ^{7/8}	15	◆ (1) DR1842		

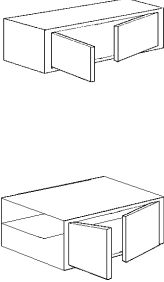
Wall - Depth: 15" (Double Door)						
	Frame Construction					
	W361215	36	12	15	◆ (2) DR1218	No Shelf
	W301815	30	18	15	◆ (2) DR1518	[No Shelf
	W361815	36	18	15	◆ (2) DR1818	
	W302415	30	23 ^{5/8}	15	◆ (2) DR1524	[(1) 15" deep shelf
	W362415	36	23 ^{5/8}	15	◆ (2) DR1824	
W303015	30	30 ^{9/16}	15	◆ (2) DR1530	[(2) 15" deep shelves	
W363015	36	30 ^{9/16}	15	◆ (2) DR1830		

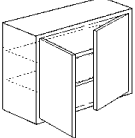
Wall - Depth: 15" (Double Door) Not Offered In Gatehouse Series						
	Frame Construction					
	W303615	30	36	15	◆ (2) DR1536	[(2) 15" deep shelves
	W363615	36	36	15	◆ (2) DR1836	
	W304215	30	41 ^{7/8}	15	◆ (2) DR1542	[(3) 15" deep shelves
W364215	36	41 ^{7/8}	15	◆ (2) DR1842		

Wall - Depth: 15" (Triple Door)						
	Frame Construction					
	W481215 L/R	48	12	15	◆ (2) DR1612 (1)DR1512	[No Shelf L/R designates hinging of single door
	W481815 L/R	48	18	15	◆ (2) DR1618 (1)DR1518	
	W482415 L/R	48	24	15	◆ (2) DR1624 (1)DR1524	
W483015 L/R	48	30	15	◆ (2) DR1630 (1)DR1530		

Wall Cabinetry : Cabinet Selection

Wall Cabinets

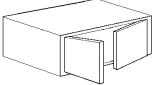
	W	H	D	Cabinet Doors		
Wall - Depth: 24" (Double Door) Frame Construction						
	W331224	33	12	24	◆ (2) DR1612	No Shelf
	W361224	36	12	24	◆ (2) DR1812	
	W391224	39	12	24	◆ (2) DR1912	
	W421224	42	12	24	◆ (2) DR2112	
	W331524	33	15	24	◆ (2) DR1615	
	W361524	36	15	24	◆ (2) DR1815	
	W391524	39	15	24	◆ (2) DR1915	
	W331824	33	18	24	◆ (2) DR1618	
	W361824	36	18	24	◆ (2) DR1818	
	W391824	39	18	24	◆ (2) DR1918	
	W421824	42	18	24	◆ (2) DR2118	
	W332424	33	23 ^{5/8}	24	◆ (2) DR1624	
	W362424	36	23 ^{5/8}	24	◆ (2) DR1824	
	W392424	39	23 ^{5/8}	24	◆ (2) DR1924	

	W	H	D	Cabinet Doors		
Wall - Depth: 24" (Triple Door) Frame Construction						
	W481224 L/R	48	12	24	◆ (2) DR1612 (1) DR1512	No Shelf L/R designates hinging of single door
	W481824 L/R	48	18	24	◆ (2) DR1618 (1) DR1518	

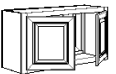
	W	H	D	Cabinet Doors		
Wall Double Face - Height: 18" (Four Doors) Frame Construction						
	WDF3018	30	18	12	◆ (4) DR1518	No Shelf Double Face Frames
	WDF3618	36	18	12	◆ (4) DR1818	

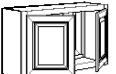
	W	H	D	Cabinet Doors		
Wall Double Face - Height: 24" (Four Doors) Frame Construction						
	WDF3024	30	23 ^{5/8}	12	◆ (4) DR1524	1 Adjustable Shelf Double Face Frames
	WDF3624	36	23 ^{5/8}	12	◆ (4) DR1824	

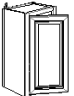
	W	H	D	Cabinet Doors		
Wall Double Face - Height: 30" (Two Doors) Frame Construction						
	WDF1530 L/R	15	30 ^{9/16}	12	◆ (2) DR1530	2 Adjustable Shelves Double Face Frames
	WDF1830 L/R	18	30 ^{9/16}	12	◆ (2) DR1830	

	W	H	D	Cabinet Doors		
Wall Double Face - Height: 30" (Four Doors) Frame Construction						
	WDF3030	30	30 ^{9/16}	12	◆ (4) DR1530	2 Adjustable Shelves Double Face Frames
	WDF3630	36	30 ^{9/16}	12	◆ (4) DR1830	

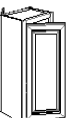
	W	H	D	Cabinet Doors		
Wall Double Face - Height: 36" (Two Doors) Frame Construction						
	WDF1536 L/R	15	36	12	◆ (2) DR1536	2 Adjustable Shelves Double Face Frames
	WDF1836 L/R	18	36	12	◆ (2) DR1836	

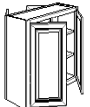
	W	H	D	Cabinet Doors		
Wall Double Face - Height: 36" (Four Doors) Frame Construction						
	WDF3036	30	36	12	◆ (4) DR1536	2 Adjustable Shelves Double Face Frames
	WDF3636	36	36	12	◆ (4) DR1836	

Wall Cabinetry : Cabinet Selection

Wall Cabinets

	W	H	D	Cabinet Doors		Frame Construction
--	---	---	---	---------------	--	--------------------

Wall Double Face - Height: 42" (Two Doors)

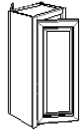

WDF1542 L/R	15	41 ^{7/8}	12	◆ (2) DR1542	3 Adjustable Shelves Double Face Frames
WDF1842 L/R	18	41 ^{7/8}	12	◆ (2) DR1842	

Wall Double Face - Height: 42" (Four Doors)

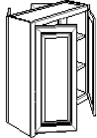

WDF3042	30	41 ^{7/8}	12	◆ (4) DR1542	3 Adjustable Shelves Double Face Frames
WDF3642	36	41 ^{7/8}	12	◆ (4) DR1842	

Wall Wine Rack Lattice (Double Doors)

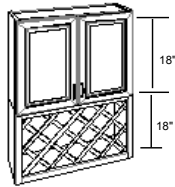

WRL3036 shown

	W	H	D	Cabinet Doors		Frame Construction
WRL3030	30	30 ^{9/16}	12	◆ (2) DR1512	Finished Interior No shelf in upper section 18" Rack Lattice	* Holds 15 bottles
WRL3630	36	30 ^{9/16}	12	◆ (2) DR1812		* Holds 22 bottles
WRL3036	30	36	12	◆ (2) DR1518	Finished Interior No shelf in upper section 18" Rack Lattice	* Holds 15 bottles
WRL3636	36	36	12	◆ (2) DR1818		* Holds 22 bottles
WRL3042	30	41 ^{7/8}	12	◆ (2) DR1524	1 Adjustable Shelf Finished Interior 18" Rack Lattice	* Holds 15 bottles
WRL3642	36	41 ^{7/8}	12	◆ (2) DR1824		* Holds 22 bottles

Wine Rack Lattice - Height: 18"

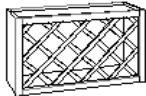

	W	H	D	Cabinet Doors		Frame Construction
WRL3018	30	18	12		Finished Interior 18" Rack Lattice	* Holds 15 bottles
WRL3618	36	18	12			* Holds 22 bottles

Wine Stem Rack

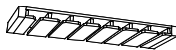

	W	H	D	Cabinet Doors		Frame Construction
WSR3002	30	2	12		All Sides Finished	* Holds 7 glasses
WSR3602	36	2	12			* Holds 9 glasses

**Installation Note: Trimming Is NOT Recommended*

Wall Pigeon Hole (Double Doors)

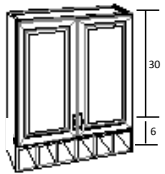

WPH3636 shown

	W	H	D	Cabinet Doors		Frame Construction
WPH3030	30	30 ^{9/16}	12	◆ (2) DR1524	1 Adjustable Shelf Finished Interior Slot = 5 1/8" Wide	* Has 5 slots
WPH3630	36	30 ^{9/16}	12	◆ (2) DR1824		* Has 6 slots
WPH3036	30	36	12	◆ (2) DR1530	1 Adjustable Shelf Finished Interior Slot = 5 1/8" Wide	* Has 5 slots
WPH3636	36	36	12	◆ (2) DR1830		* Has 6 slots
WPH3042	30	41 ^{7/8}	12	◆ (2) DR1536	2 Adjustable Shelves Finished Interior Slot = 5 1/8" Wide	* Has 5 slots
WPH3642	36	41 ^{7/8}	12	◆ (2) DR1836		* Has 6 slots

Wall Plate Rack (Double Doors)



WPR3036 shown

	W	H	D	Cabinet Doors		Frame Construction
WPR3030	30	30 ^{9/16}	12	◆ (2) DR1512	No Shelf Finished Interior	* Holds 13 Plates
WPR3630	36	30 ^{9/16}	12	◆ (2) DR1812		* Holds 17 Plates
WPR3036	30	36	12	◆ (2) DR1518	No Shelf Finished Interior	* Holds 13 Plates
WPR3636	36	36	12	◆ (2) DR1818		* Holds 17 Plates
WPR3042	30	41 ^{7/8}	12	◆ (2) DR1524	1 Adjustable Shelf Finished Interior	* Holds 13 Plates
WPR3642	36	41 ^{7/8}	12	◆ (2) DR1824		* Holds 17 Plates

Wall Cabinetry : Cabinet Selection

Wall Cabinets

	W	H	D	Cabinet Doors	Frame Construction	
Wall Microwave Cabinet (Double Doors)						
<p>MW3030 shown</p>	MW3030	30	30 ^{9/16}	12	◆ (2) DR1512	Finished Interior Microwave shelf is 16 1/2" deep
	MW2436	24	36	12	◆ (2) DR1218	Finished Interior Microwave shelf is 16 1/2" deep
	MW3036	30	36	12	◆ (2) DR1518	Finished Interior Microwave shelf is 16 1/2" deep
	MW2442	24	41 ^{7/8}	12	◆ (2) DR1224	Finished Interior Microwave shelf is 16 1/2" deep
	MW3042	30	41 ^{7/8}	12	◆ (2) DR1524	1 Adjustable shelf

The MW24 opening is 21 3/4" wide and MW30 opening is 27 3/4" wide

	W	H	D	Cabinet Doors	Frame Construction	
Wall Corner 24" (Single Door)						
	WC2418 L/R	24	18	24	◆ (1) DR1518	No Shelf
	WC2430 L/R	24	30 ^{9/16}	24	◆ (1) DR1536	2 Adjustable Shelves
	WC2436 L/R	24	36	24	◆ (1) DR1536	
	WC2442 L/R	24	41 ^{7/8}	24	◆ (1) DR1542	3 Adjustable Shelves
	WC2448 L/R	24	48	25	◆ (1) DR1548	3 Adjustable Shelves **Only Available In Vassar House

	W	H	D	Cabinet Doors	Frame Construction	
Wall Corner 27" (Single Door)						
	WC2718 L/R	27	18	27	◆ (1) DR1518	No Shelf
	WC2730 L/R	27	30 ^{9/16}	27	◆ (1) DR1530	2 Adjustable Shelves
	WC2736 L/R	27	36	27	◆ (1) DR1536	
	WC2742 L/R	27	41 ^{7/8}	27	◆ (1) DR1542	3 Adjustable Shelves
	WC2748 L/R	27	48	28	◆ (1) DR1548	

	W	H	D	Cabinet Doors	Frame Construction	
Wall Corner Lazy Susan 24" (Single Door)						
	WCLS2430 L/R	24	30 ^{9/16}	24	◆ (1) DR1530	1 - Adjustable shelf with Rotating Lazy Susan attached
	WCLS2436 L/R	24	36	24	◆ (1) DR1536	1 - Rotating Lazy Susan attached to cabinet bottom
	WCLS2442 L/R	24	41 ^{7/8}	24	◆ (1) DR1542	2 - Adjustable shelves with Rotating Lazy Susans attached 1 - Rotating Lazy Susan attached to cabinet bottom

	W	H	D	Cabinet Doors	Frame Construction	
Wall Corner Lazy Susan 27" (Single Door)						
	WCLS2730 L/R	27	30 ^{9/16}	27	◆ (1) DR1530	1 - Adjustable shelf with Rotating Lazy Susan attached
	WCLS2736 L/R	27	36	27	◆ (1) DR1536	1 - Rotating Lazy Susan attached to cabinet bottom
	WCLS2742 L/R	27	41 ^{7/8}	27	◆ (1) DR1542	2 - Adjustable shelves with Rotating Lazy Susans attached 1 - Rotating Lazy Susan attached to cabinet bottom

	W	H	D	Cabinet Doors	Frame Construction	
Wall Double Face Corner (Triple Door)						
	WDFC2430 L/R	24	30 ^{9/16}	24	◆ (2) DR1230 & (1) DR1530	2 Adjustable Shelves
	WDFC2436 L/R	24	36	24	◆ (2) DR1236 & (1) DR1536	
	WDFC2442 L/R	24	41 ^{7/8}	24	◆ (2) DR1242 & (1) DR1542	3 Adjustable Shelves

Wall Cabinetry : Cabinet Selection

Wall Cabinets

		W	H	D	Cabinet Doors	
--	--	---	---	---	---------------	--

Wall Blind Corner - Height: 30" Frame Construction

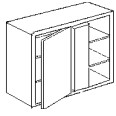

WBC27/3030 L/R	27	30 ^{9/16}	12	◆ (1) DR1230
WBC36/3930 L/R	36	30 ^{9/16}	12	◆ (1) DR2130

- 2 Adjustable Shelves
- 3" Corner Overlay Filler INCLUDED
- 6" Cover Overlay Filler -ATTACHED
- Closure Panel for Blind Attached
- L/R designates position of Blind Side

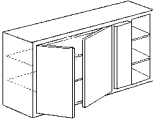

WBC42/4530 L/R	42	30 ^{9/16}	12	◆ (2) DR1330
-----------------------	----	--------------------	----	--------------

- 2 Adjustable Shelves
- 3" Corner Overlay Filler INCLUDED
- 6" Cover Overlay Filler -ATTACHED
- Closure Panel for Blind Attached
- L/R designates position of Blind Side

Wall Blind Corner - Height: 36" Frame Construction

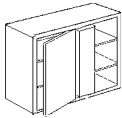

WBC 27/3036 L/R	27	36	12	◆ (1) DR1236
WBC 36/3936 L/R	36	36	12	◆ (1) DR2136

- 2 Adjustable Shelves
- 3" Corner Overlay Filler INCLUDED
- 6" Cover Overlay Filler Attached
- Closure Panel for Blind Attached
- L/R designates position of Blind side

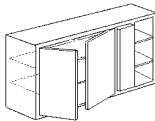

WBC 42/4536 L/R	42	36	12	◆ (2) DR1336
------------------------	----	----	----	--------------

- 2 Adjustable Shelves
- 3" Corner Overlay Filler INCLUDED
- 6" Cover Overlay Filler Attached
- Closure Panel for Blind Attached
- L/R designates position of Blind side

Wall Blind Corner - Height: 42" Frame Construction

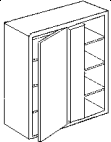

WBC 27/3042 L/R	36	41 ^{7/8}	12	◆ (1) DR1242
WBC 36/3942 L/R	36	41 ^{7/8}	12	◆ (1) DR2142

- 3 Adjustable Shelves
- 3" Corner Overlay Filler INCLUDED
- 6" Cover Overlay Filler Attached
- Closure Panel for Blind Attached
- L/R designates position of Blind side

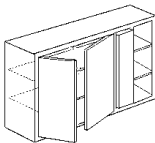

WBC 42/4542 L/R	42	41 ^{7/8}	12	◆ (2) DR1342
------------------------	----	-------------------	----	--------------

- 3 Adjustable Shelves
- 3" Corner Overlay Filler INCLUDED
- 6" Cover Overlay Filler Attached
- Closure Panel for Blind Attached
- L/R designates position of Blind side

Wall Blind End Corner - Height: 30" (Single Door) Full Access Construction

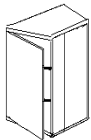

WBEC24/2730 L/R	24	30 ^{9/16}	12	◆ (1) DR1530
WBEC30/3330 L/R	24	30 ^{9/16}	12	◆ (1) DR1530 (1) DR0630

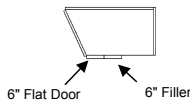

- 2 Fixed Shelves
- 3" Corner Overlay Filler INCLUDED
- 6" Cover Overlay Filler Attached
- Closure Panel for Blind Attached
- L/R designates position of Blind Side
- WEC2430 box

Cabinet	Cabinet Width	Door Width	Minimum Pull	Maximum Pull
WBC27/3030L/R	27"	12"	27"	30"
WBC36/3930L/R	36"	21"	36"	39"
WBC42/4530L/R	42"	2) *13"	42"	45"

*WBC42/4530L/R is a double door cabinet.

Cabinet	Cabinet Width	Angled Door Width	Blind Door Width	Minimum Pull	Maximum Pull
WBEC24/2730L/R	24	15"	None	24	27
WBEC30/3330L/R	24	15"	6"	30	33
WBEC36/3930L/R	36	15"	12"	36	39
WBEC39/4230L/R	36	15"	15"	39	42
WBEC42/4530L/R	36	15"	18"	42	45
WBEC45/4830L/R	36	15"	21"	45	48

*The door at angled end is always 15" wide

Wall Cabinetry : Cabinet Selection

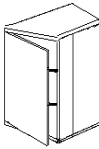
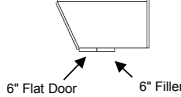
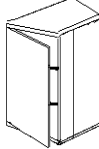
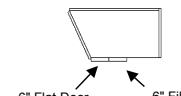
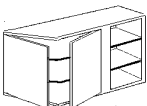
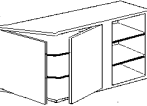
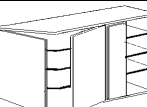
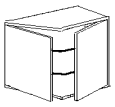
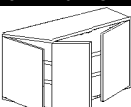
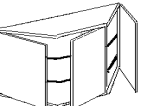
Wall Cabinets		W	H	D	Cabinet Doors	
Wall Blind End Corner - Height: 36" (Single Door) Full Access Construction						
	WBEC24/2736 L/R	24	36	12	◆ (1) DR1536	2 Fixed Shelves 3" Corner Overlay Filler INCLUDED 6" Cover Overlay Filler Attached Closure Panel for Blind Attached L/R designates position of Blind Side WEC2436 box
	WBEC30/3336 L/R	24	36	12	◆ (1) DR1536 (1) DR0636	
						
Wall Blind End Corner - Height: 42" (Single Door) Full Access Construction						
	WBEC24/2742 L/R	24	41 ^{7/8}	12	◆ (1) DR1542	3 Fixed Shelves 3" Corner Overlay Filler INCLUDED 6" Cover Overlay Filler Attached Closure Panel for Blind Attached L/R designates position of Blind Side WEC2442 box
	WBEC30/3342 L/R	24	41 ^{7/8}	12	◆ (1) DR1542 (1) DR0642	
						
Wall Blind End Corner - Height: 30" (Double Door) Full Access Construction						
	WBEC36/3930 L/R	36	30 ^{9/16}	12	◆ (1) DR1530 (1) DR1230	2 Fixed Shelves 3" Corner Overlay Filler INCLUDED 6" Cover Overlay Filler Attached Closure Panel for Blind Attached L/R designates position of Blind Side WEC3630 box
	WBEC39/4230 L/R	36	30 ^{9/16}	12	◆ (1) DR1530 (1) DR1530	
	WBEC42/4530 L/R	36	30 ^{9/16}	12	◆ (1) DR1530 (1) DR1830	
	WBEC45/4830 L/R	36	30 ^{9/16}	12	◆ (1) DR1530 (1) DR2130	
	<small>WBEC36/3930R</small>					
Wall Blind End Corner - Height: 36" (Double Door) Full Access Construction						
	WBEC36/3936 L/R	36	36	12	◆ (1) DR1536 (1) DR1236	2 Fixed Shelves 3" Corner Overlay Filler INCLUDED 6" Cover Overlay Filler Attached Closure Panel for Blind Attached L/R designates position of Blind Side WEC3636 box
	WBEC39/4236 L/R	36	36	12	◆ (1) DR1536 (1) DR1536	
	WBEC42/4536 L/R	36	36	12	◆ (1) DR1536 (1) DR1836	
	WBEC45/4836 L/R	36	36	12	◆ (1) DR1536 (1) DR2136	
	<small>WBEC36/3936R</small>					
Wall Blind End Corner - Height: 42" (Double Door) Full Access Construction						
	WBEC36/3942 L/R	36	41 ^{7/8}	12	◆ (1) DR1542 (1) DR1242	3 Fixed Shelves 3" Corner Overlay Filler INCLUDED 6" Cover Overlay Filler Attached Closure Panel for Blind Attached L/R designates position of Blind Side WEC3642 box
	WBEC39/4242 L/R	36	41 ^{7/8}	12	◆ (1) DR1542 (1) DR1542	
	WBEC42/4542 L/R	36	41 ^{7/8}	12	◆ (1) DR1542 (1) DR1842	
	WBEC45/4842 L/R	36	41 ^{7/8}	12	◆ (1) DR1542 (1) DR2142	
	<small>WBEC36/3942R</small>					
Wall End Corner (Double Door) Full Access Construction						
	WEC2418 L/R	24	18	12	◆ (2) DR1518	No Shelf
	WEC2430 L/R	24	30 ^{9/16}	12	◆ (2) DR1530	2 Fixed Shelves
	WEC2436 L/R	24	36	12	◆ (2) DR1536	
		<small>WEC2430R</small>				
	WEC2442 L/R	24	41 ^{7/8}	12	◆ (2) DR1542	3 Fixed Shelves
Wall End Corner (Triple Door) Full Access Construction						
	WEC3630 L/R	36	30 ^{9/16}	12	◆ (1) DR1530 (2) DR1330	2 Fixed Shelves
	WEC3636 L/R	36	36	12	◆ (1) DR1536 (2) DR1336	
		<small>WEC3630R</small>				
	WEC3642 L/R	36	41 ^{7/8}	12	◆ (1) DR1542 (2) DR1342	3 Fixed Shelves
Wall End Corner Double Face (Triple Door) Full Access Construction						
	WECDF3630 L/R	36	30 ^{9/16}	12	◆ (2) DR1530 (1) DR1830	2 Fixed Shelves
	WECDF3636 L/R	36	36	12	◆ (2) DR1536 (1) DR1836	
		<small>WECDF3630R</small>				
	WECDF3642 L/R	36	41 ^{7/8}	12	◆ (2) DR1542 (1) DR1842	3 Fixed Shelves

Wall Cabinetry : Cabinet Selection

Wall Cabinets

	W	H	D	Cabinet Doors	Frame Construction
--	---	---	---	---------------	--------------------

Wall Drawer - Height: 48" (Single Door)

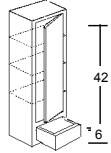

WD1548R

WD1548 L/R	15	48	12	◆ (1) DR1542 (1) DH1506
WD1848 L/R	18	48	12	◆ (1) DR1842 (1) DH1806

Vassar House Series has (1) DH1505.5 or DH1805.5

- 3 Adjustable Shelves
- Finished Interior-STANDARD
- 1 Drawer with full extension glides
- Soft Close Glides are NOT available

Wall Drawer - Height: 48" (Double Door)

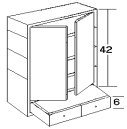

WD3048

WD3048	30	48	12	◆ (2) DR1542 (2) DH1506
WD3648	36	48	12	◆ (2) DR1842 (2) DH1806

Vassar House Series has (2) DH1505.5 or DH1805.5

- 3 Adjustable Shelves
- Finished Interior-STANDARD
- 1 Drawer with full extension glides
- Soft Close Glides are NOT available

Wall Drawer - Height: 54" (Single Door)

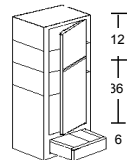

WD1554R

WD1554 L/R	15	54	12	◆ (1) DR1548-WD (1) DH1506
WD1854 L/R	18	54	12	◆ (1) DR1848-WD (1) DH1806

- 3 Adjustable Shelves
- Finished Interior-STANDARD
- 1 Drawer with full extension glides
- Soft Close Glides are NOT available

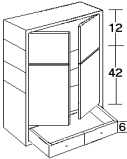

WD3054

WD3054	30	54	12	◆ (2) DR1548-WD (2) DH1506
WD3654	36	54	12	◆ (2) DR1848-WD (2) DH1806

- 3 Adjustable Shelves
- Finished Interior-STANDARD
- 1 Drawer with full extension glides
- Soft Close Glides are NOT available

Wall Drawer - Height: 60" (Single Door)

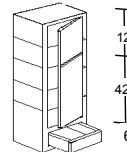

WD1560

WD1560 L/R	15	60	12	◆ (1) DR1554-WD (1) DH1506
WD1860 L/R	18	60	12	◆ (1) DR1854-WD (1) DH1806

- 4 Adjustable Shelves
- Finished Interior-STANDARD
- 1 Drawer with full extension glides
- Soft Close Glides are NOT available



WD3060

WD3060	30	60	12	◆ (2) DR1554-WD (2) DH1506
WD3660	36	60	12	◆ (2) DR1854-WD (2) DH1806

- 4 Adjustable Shelves
- Finished Interior-STANDARD
- 1 Drawer with full extension glides
- Soft Close Glides are NOT available

Wall Drawer - Depth 15" - Height: 48" (Single Door)

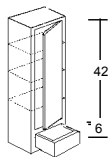

WD1548R

WD154815 L/R	15	48	15	◆ (1) DR1542 (1) DH1506
WD184815 L/R	18	48	15	◆ (1) DR1842 (1) DH1806

Vassar House Series has (1) DH1505.5 or DH1805.5

- 3 Adjustable 15" deep shelves
- Finished Interior-STANDARD
- 1 Drawer with full extension glides
- Soft Close Glides are NOT available

Wall Drawer - Depth 15" - Height: 48" (Double Door)

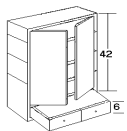





WD3048

WD304815	30	48	15	◆ (2) DR1542 (2) DH1506
WD364815	36	48	15	◆ (2) DR1842 (2) DH1806

Vassar House Series has (2) DH1505.5 or DH1805.5

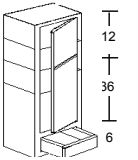
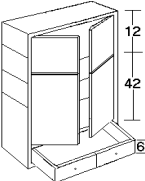
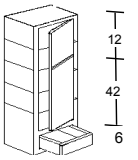
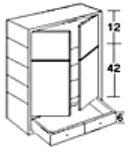
- 3 Adjustable 15" deep shelves
- Finished Interior-STANDARD
- 1 Drawer with full extension glides
- Soft Close Glides are NOT available

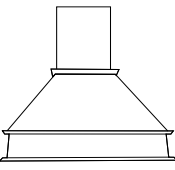
Wall Cabinetry : Cabinet Selection

Wall Cabinets		W	H	D	Cabinet Doors	
Wall Drawer - Depth 15" - Height: 54" (Single Door)						Frame Construction
 <p>WD1554R</p>	WD155415 L/R	15	54	15	◆ (1) DR1548-WD (1) DH1506	3 Adjustable 15" deep shelves Finished Interior-STANDARD 1 Drawer with full extension glides Soft Close Glides are NOT Available
	WD185415 L/R	18	54	15	◆ (1) DR1848-WD (1) DH1806	
 <p>WD3054</p>	WD305415	30	54	15	◆ (2) DR1548-WD (2) DH1506	3 Adjustable 15" deep shelves Finished Interior-STANDARD 1 Drawer with full extension glides Soft Close Glides are NOT Available
	WD365415	36	54	15	◆ (2) DR1848-WD (2) DH1806	
Wall Drawer - Depth 15" - Height: 60" (Single Door)						Frame Construction
 <p>WD1560</p>	WD156015 L/R	15	60	15	◆ (1) DR1554-WD (1) DH1506	4 Adjustable 15" deep shelves Finished Interior-STANDARD 1 Drawer with full extension glides Soft Close Glides are NOT Available
	WD186015 L/R	18	60	15	◆ (1) DR1854-WD (1) DH1806	
 <p>WD3060</p>	WD306015	30	60	15	◆ (2) DR1554-WD (2) DH1506	4 Adjustable 15" deep shelves Finished Interior-STANDARD 1 Drawer with full extension glides Soft Close Glides are NOT Available
	WD366015	36	60	15	◆ (2) DR1854-WD (2) DH1806	
Lift-Up Door Appliance Garage		Not Offered In Gatehouse Series			Frameless Construction	
 <p>BLUM1818</p>	BLUM1818	18	18	12	◆ (1) DR1818	Open Bottom
	BLUM3018	30	18	12	◆ (1) DR1830	Door pulls forward and then upwards
	BLUM3618	36	18	12	◆ (1) DR1836	
Range Hood		Not Offered In Gatehouse Series				
	RH3630	36	30	24		Duct Cover Included Need Alumasteel Liner Not Door Style Specific
	RH4230	42	30	24		
	RH5430	54	30	24		
Wine Rack Diagonal					Frameless Construction	
 <p>WRD1515</p>	WRD1515	15	15	12		Holds 12 Wine Bottles All 4 Sides Finished Standard Closed Back 5/8" Thick Construction
	WRD1818	18	18	12		

Wall Cabinetry : Frame with Doors

Wall Cabinets

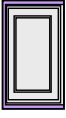
		W	H	D	Cabinet Doors	Frame Construction	
DRFF ("Door Face Frame") Single Door							
	DRFF1236	12	36	3/4	◆ (1) DR1236	Face Frame with Doors and Hinges Attached Can be used for Grottos to access duct, fan or motor.	
	DRFF1530	15	30 ^{9/16}	3/4	◆ (1) DR1830		
	DRFF1536	15	36	3/4	◆ (1) DR1536		
	DRFF1542	15	41 ^{7/8}	3/4	◆ (1) DR1542		
	DRFF1830	18	30 ^{9/16}	3/4	◆ (1) DR1830		
	DRFF1836	18	36	3/4	◆ (1) DR1836		
	DRFF1842	18	41 ^{7/8}	3/4	◆ (1) DR1842		
	DRFF2130	21	30 ^{9/16}	3/4	◆ (1) DR2130		
	DRFF2142	21	41 ^{7/8}	3/4	◆ (1) DR2142		

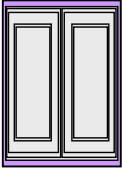
		W	H	D	Cabinet Doors	Frame Construction	
DRFF ("Door Face Frame") Double Door							
	DRFF2418	24	18	3/4	◆ (2) DR1218	Face Frame with Doors and Hinges Attached Can be used for Grottos to access duct, fan or motor.	
	DRFF2424	24	23 ^{5/8}	3/4	◆ (2) DR1224		
	DRFF2430	24	30 ^{9/16}	3/4	◆ (2) DR1230		
	DRFF2730	27	30 ^{9/16}	3/4	◆ (2) DR1330		
	DRFF2736	27	36	3/4	◆ (2) DR1336		
	DRFF3012	30	12	3/4	◆ (2) DR1512		
	DRFF3018	30	18	3/4	◆ (2) DR1518		
	DRFF3024	30	23 ^{5/8}	3/4	◆ (2) DR1524		
	DRFF3030	30	30 ^{9/16}	3/4	◆ (2) DR1530		
	DRFF3036	30	36	3/4	◆ (2) DR1536		
	DRFF3042	30	41 ^{7/8}	3/4	◆ (2) DR1542		
	DRFF3315	33	15	3/4	◆ (2) DR1615		
	DRFF3330	33	30 ^{9/16}	3/4	◆ (2) DR1630		
	DRFF3342	33	41 ^{7/8}	3/4	◆ (2) DR1642		
	DRFF3612	36	12	3/4	◆ (2) DR1812		
	DRFF3615	36	15	3/4	◆ (2) DR1815		
	DRFF3618	36	18	3/4	◆ (2) DR1818		
	DRFF3624	36	23 ^{5/8}	3/4	◆ (2) DR1824		
	DRFF3630	36	30 ^{9/16}	3/4	◆ (2) DR1830		
	DRFF3636	36	36	3/4	◆ (2) DR1836		
	DRFF3642	36	42	3/4	◆ (2) DR1842		
	DRFF4212	42	12	3/4	◆ (2) DR2112		
	DRFF4218	42	18	3/4	◆ (2) DR2118		
	DRFF4224	42	23 ^{5/8}	3/4	◆ (2) DR2124		
DRFF4230	42	30 ^{9/16}	3/4	◆ (2) DR2130			
DRFF4236	42	36	3/4	◆ (2) DR2136			

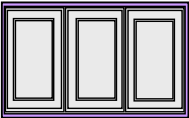
		W	H	D	Cabinet Doors	Frame Construction	
DRFF ("Door Face Frame") Triple Door							
	DRFF4812	48	12	3/4	◆ (2) DR1612 (1) DR1512	Face Frame with Doors and Hinges Attached Can be used for Grottos to access duct, fan or motor.	
	DRFF4815	48	15	3/4	◆ (2) DR1615 (1) DR1515		
	DRFF4818	48	18	3/4	◆ (2) DR1618 (1) DR1518		
	DRFF4824	48	23 ^{5/8}	3/4	◆ (2) DR1624 (1) DR1524		
	DRFF4830	48	30 ^{9/16}	3/4	◆ (2) DR1630 (1) DR1530		
	DRFF4836	48	36	3/4	◆ (2) DR1636 (1) DR1536		
	DRFF5412	54	12	3/4	◆ (3) DR1812		
	DRFF5418	54	18	3/4	◆ (3) DR1818		
	DRFF5424	54	23 ^{5/8}	3/4	◆ (3) DR1824		
	DRFF5430	54	30 ^{9/16}	3/4	◆ (3) DR1830		
	DRFF5436	54	36	3/4	◆ (3) DR1836		
	DRFF6024	60	23 ^{5/8}	3/4	◆ (2) DR2124 (1) DR1824		
	DRFF6030	60	30 ^{9/16}	3/4	◆ (2) DR2130 (1) DR1830		
	DRFF7218	72	18	3/4	◆ (4) DR1818		